



INFORMATION

Shelterbelt Establishment Program

RESOURCES

Shelterbelts provide a wide range of benefits including reducing wind speed which protects soil from erosion and aids in conserving moisture by reducing evaporation. Shelterbelts improve air quality by trapping dust and particles. They enhance biodiversity in agricultural landscapes by providing habitat for birds and beneficial wildlife. Shelterbelts can also help protect livestock from wind, snow and extreme temperatures while reducing snow drifting on roads, yards and fields.

Visit our partners website - treetime.ca - and visit the Blog and Frequently Asked Questions (FAQ) sections for a wide variety of resources and quality information. Information can also be found at the sources below:

Site Assessment to Choose Tree Species: yardwhispers.ca (blog)

Site Preparation for Successful Tree Planting: yardwhispers.ca (blog)

How to Plant a Shelterbelt: treetime.ca (frequently asked questions - planting)

Click Before You Dig: Request line locates at utilitysafety.ca

Plant Smart Around Power Lines: fortisalberta.com (about us - news & stories - safety)

Ensure trees are rooted at least eight metres from power lines as Fortis requires a minimum 6-metre side clearance from edges of the tree's foliage at maturity to the power line and /or power pole.



Planting Tree and Shrub Seedlings: awes-ab.ca (resources - articles)

Tree Care Information: yardwhispers.ca (blog)

Tree Pruning: alberta.ca/horticulture-publications (trees and shrubs)

*Shelterbelts
contribute to long-term
sustainability for
generations to come.*



780-842-4454



asbprograms@mdwainwright.ca



717 14 Ave Wainwright, AB

PLANTING PLAN EXAMPLES

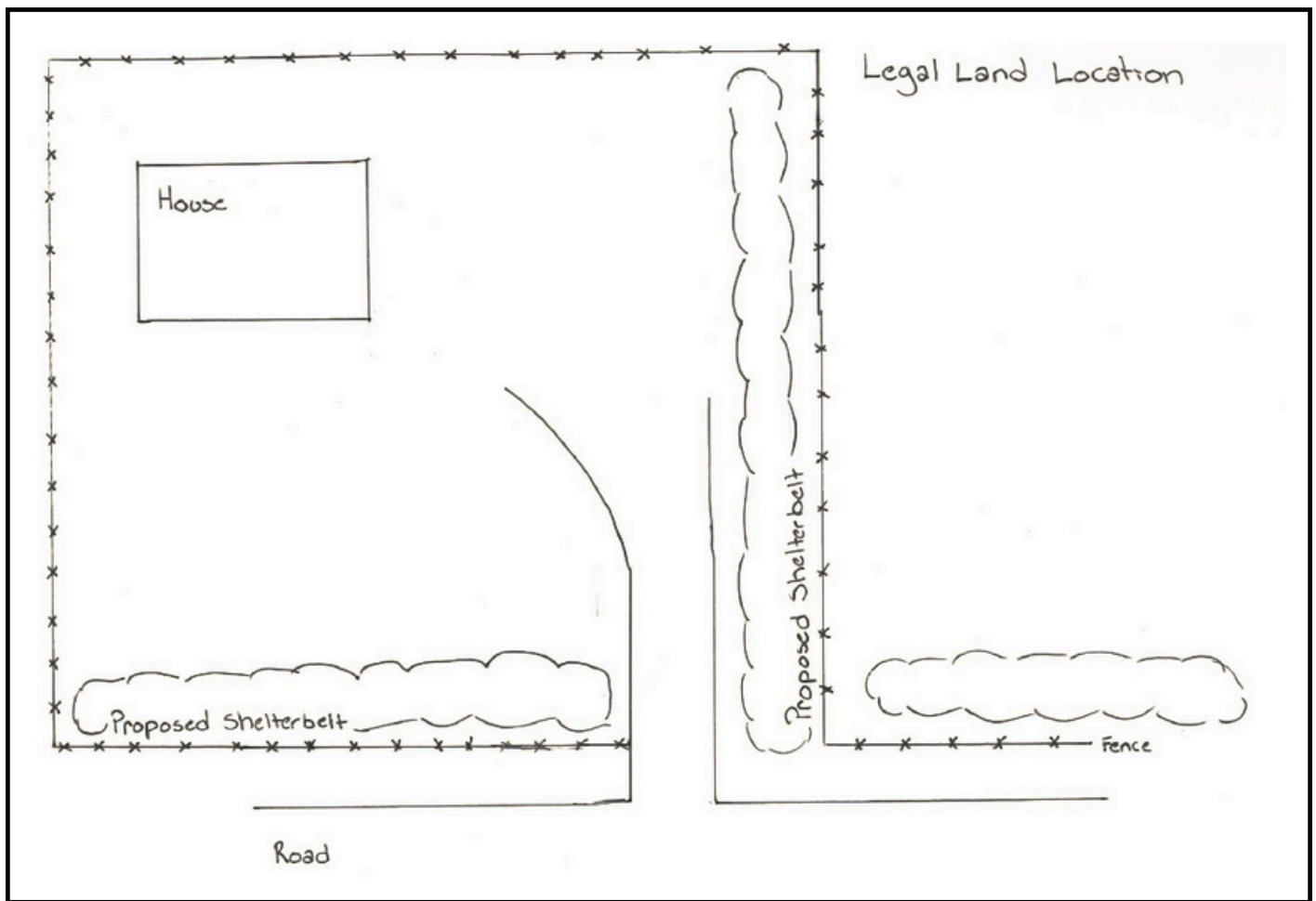

780-842-4454



asbprograms@mdwainwright.ca



717 14 Ave Wainwright, AB

DEVELOPMENT REQUIREMENTS

The planting of trees adjacent to roads shall be in accordance with the requirements in Figures 3, 4, 5 and 6 of the Municipal District of Wainwrights *Land Use Bylaw No. 1695* as amended.

For more information or questions regarding Development Requirements - please contact Director of Development Services Dana Smith at dsmith@mdwainwright.ca or by calling 780-842-4454.

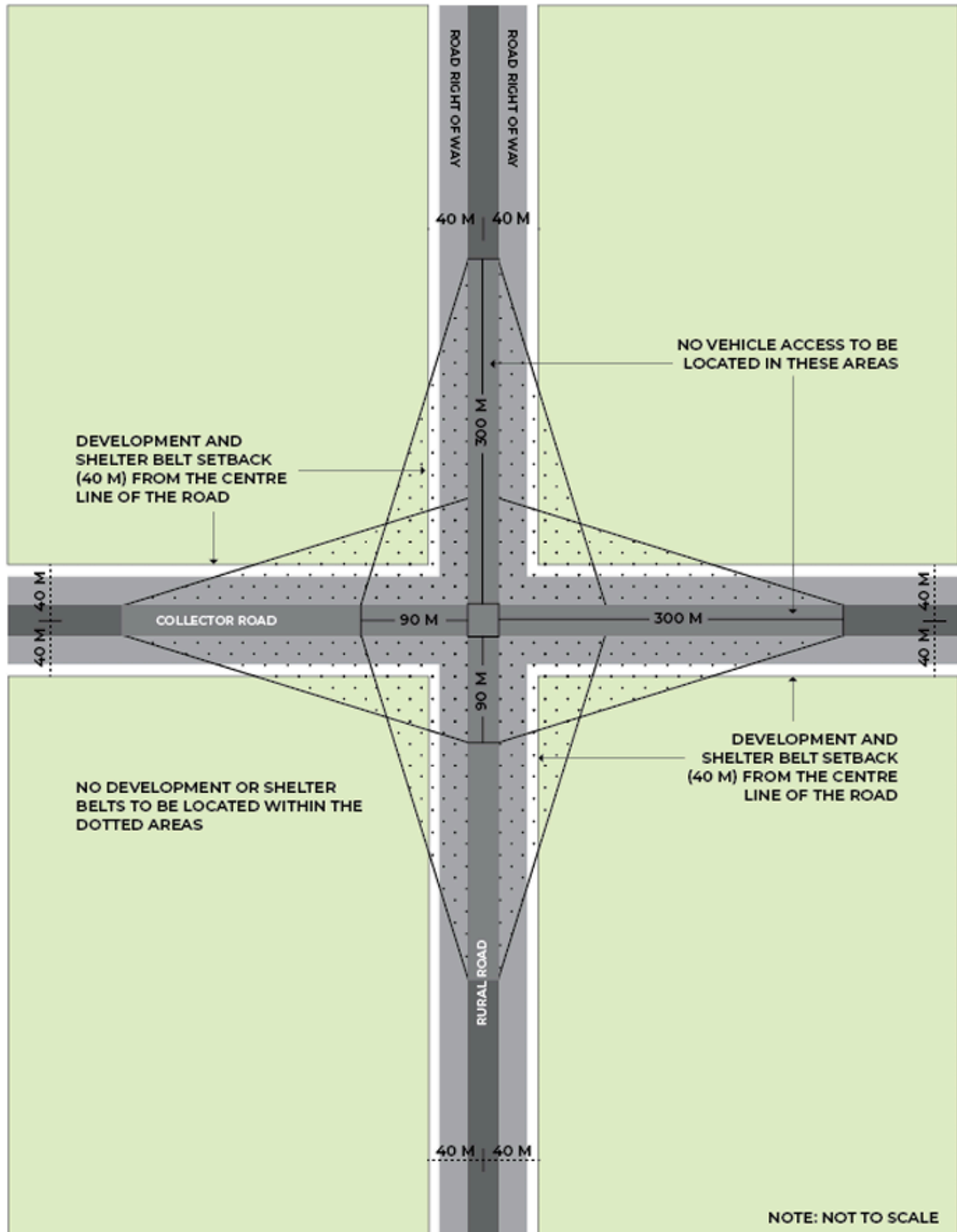

Figure 3: Setbacks at Collector Road & Rural Road



DEVELOPMENT REQUIREMENTS

The planting of trees adjacent to roads shall be in accordance with the requirements in Figures 3, 4, 5 and 6 of the Municipal District of Wainwrights *Land Use Bylaw No. 1695* as amended.

For more information or questions regarding Development Requirements - please contact Director of Development Services Dana Smith at dsmith@mdwainwright.ca or by calling 780-842-4454.

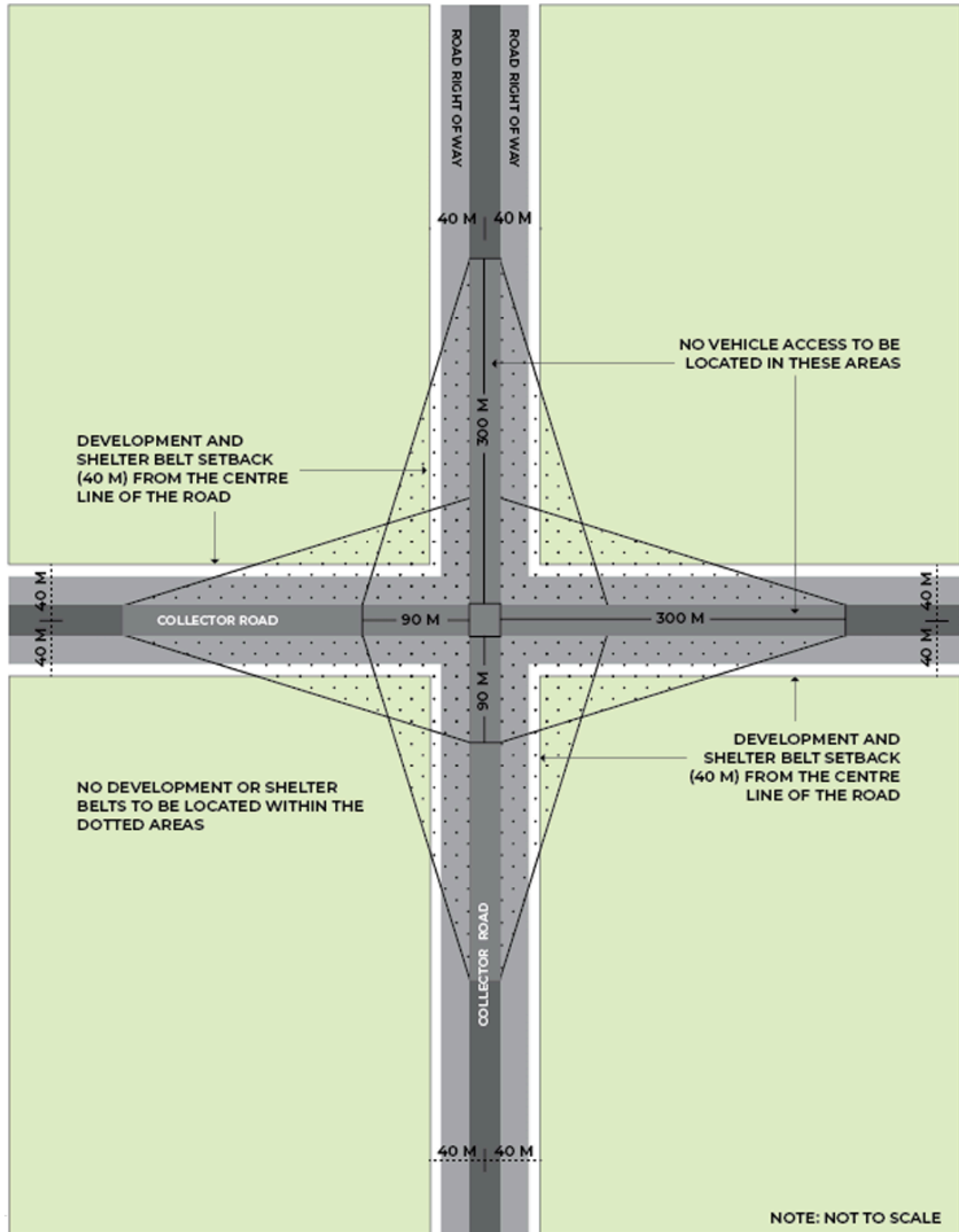

Figure 4: Setbacks at Collector Road & Collector Road



DEVELOPMENT REQUIREMENTS

The planting of trees adjacent to roads shall be in accordance with the requirements in Figures 3, 4, 5 and 6 of the Municipal District of Wainwrights *Land Use Bylaw No. 1695* as amended.

For more information or questions regarding Development Requirements - please contact Director of Development Services Dana Smith at dsmith@mdwainwright.ca or by calling 780-842-4454.

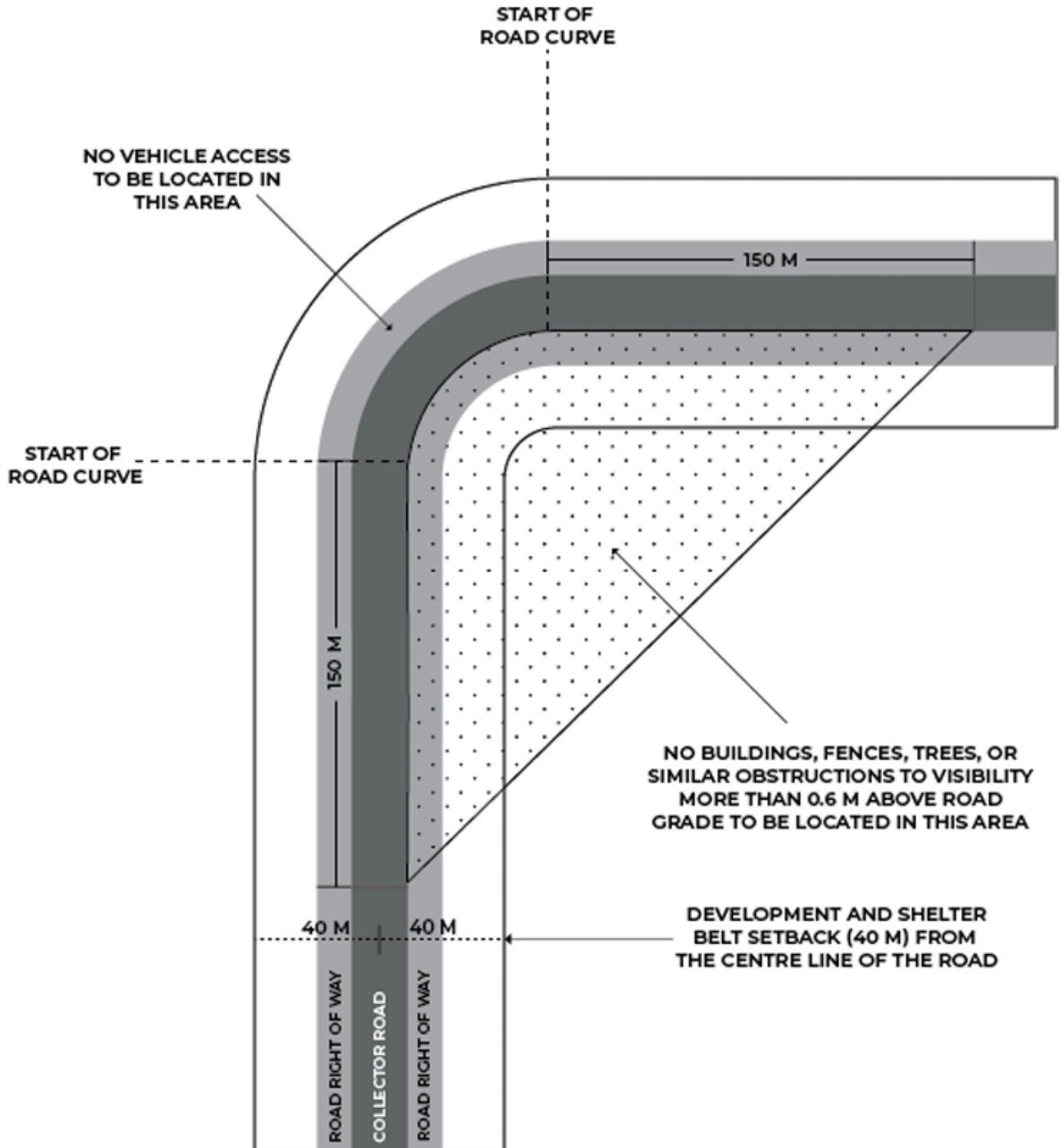

Figure 5: Setbacks at Collector Road Curve



DEVELOPMENT REQUIREMENTS

The planting of trees adjacent to roads shall be in accordance with the requirements in Figures 3, 4, 5 and 6 of the Municipal District of Wainwrights *Land Use Bylaw No. 1695* as amended.

For more information or questions regarding Development Requirements - please contact Director of Development Services Dana Smith at dsmith@mdwainwright.ca or by calling 780-842-4454.

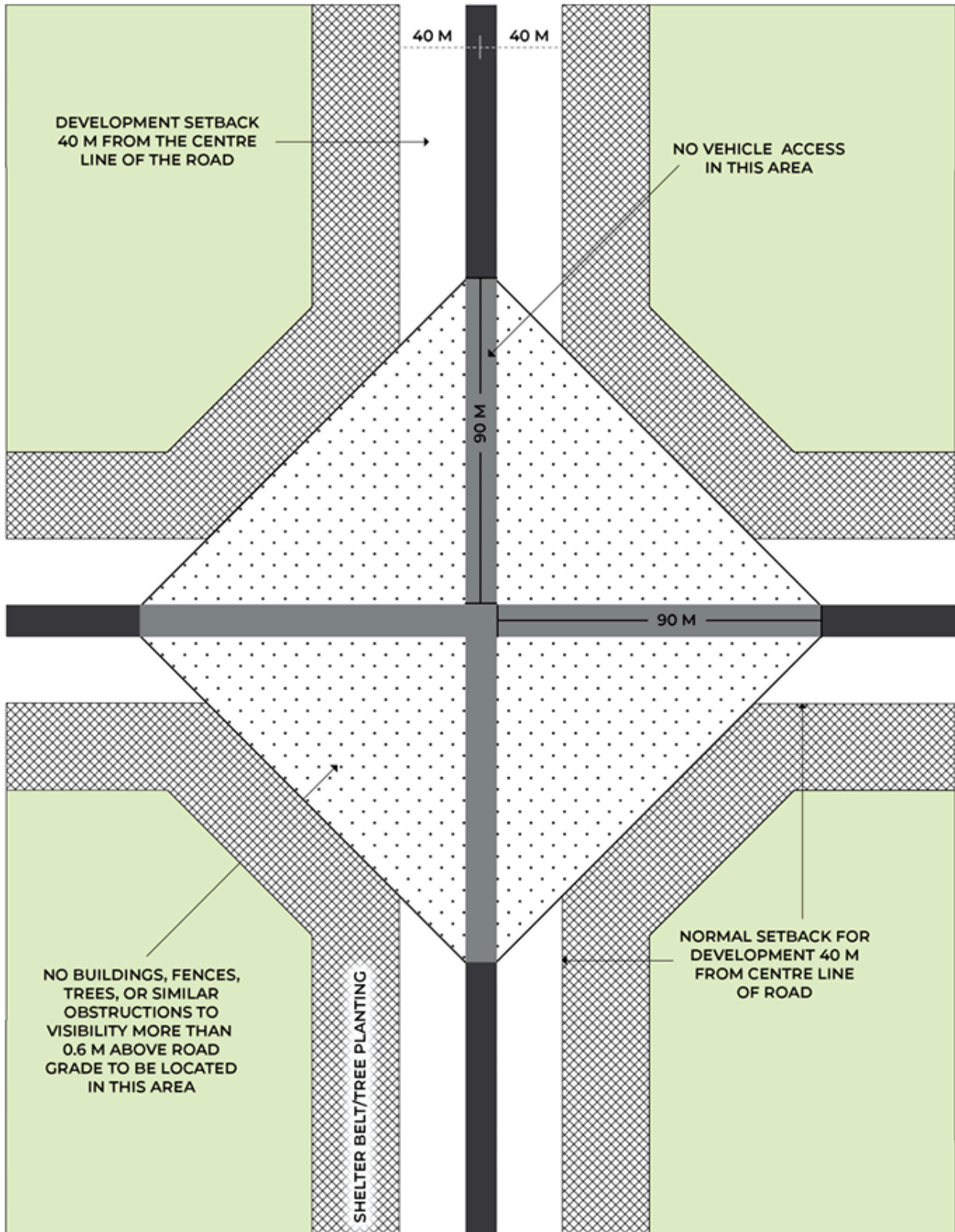

Figure 6: Setbacks at Rural Road and Rural Road



780-842-4454



asbprograms@mdwainwright.ca



717 14 Ave Wainwright, AB